

How to update Windows OS via Software Center

1086 October 7, 2021 [Windows](#) 2313

Warning: This upgrade **WILL** take over your device and may take up to **2-3 hours**.

Launching Software Center

1. (Optional) If you are using a laptop: Insert an **Ethernet cable** into the **network port** on the laptop.

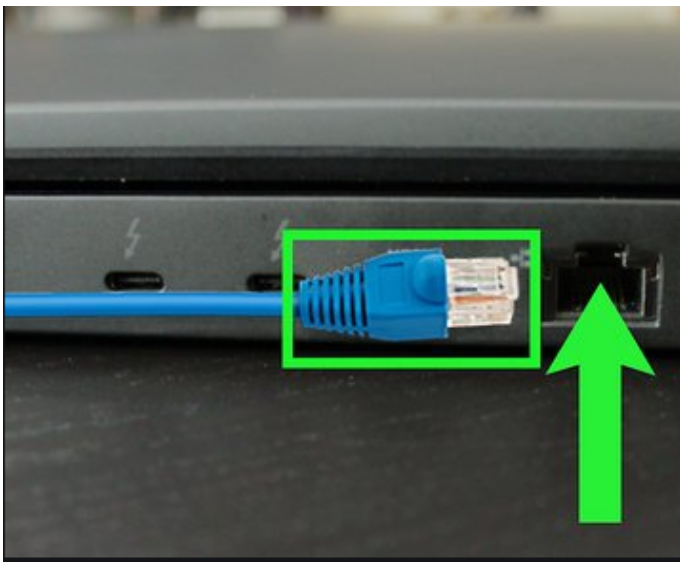

2. Click on the **Start Menu** (Windows icon at the bottom-left of the screen), then type "**WINVER**" on the search bar next to the start menu button.



3. A window will appear displaying the Windows version information. Note down the Windows OS version your device is currently running (either **1709,1809,1909**, or **20H2**).

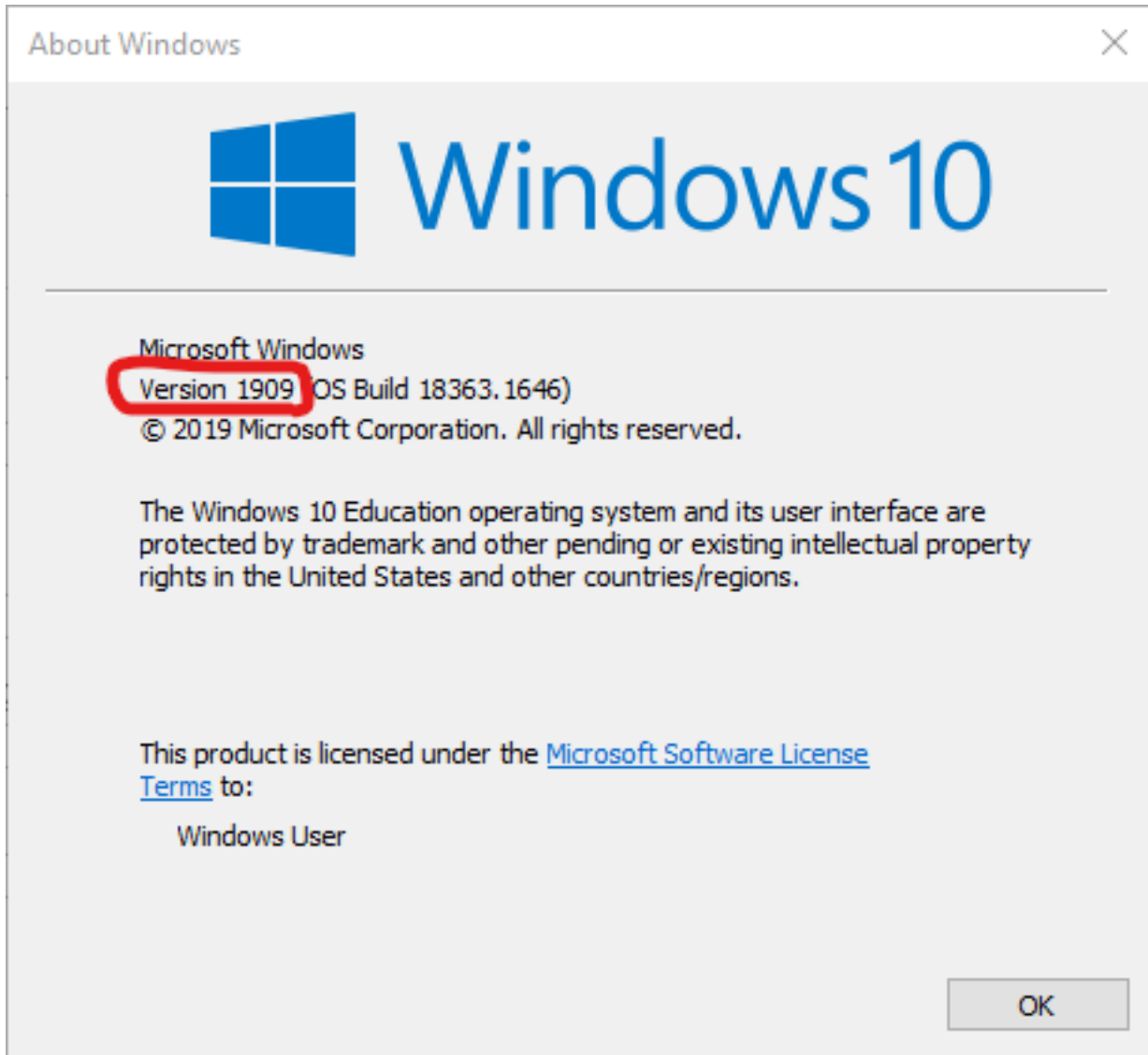

4. Restart the device while the Ethernet cable is plugged in (Choose the "**Restart**" option from the power menu).

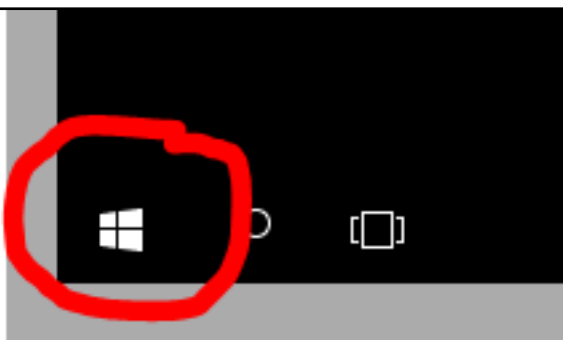

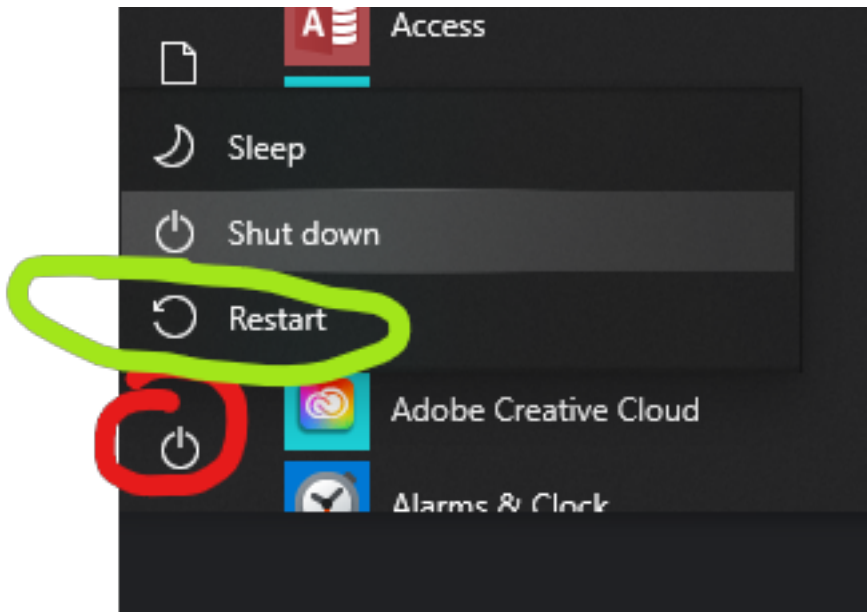

5. After restarting, log back in to the device with your LPS account.

6. Click on the **Start Menu** and type "**Software Center**" into the search bar. The Software Center app should appear in the search results.

7. Click on **Open** in the search menu or press the **enter** key on your keyboard to open the Software Center app.

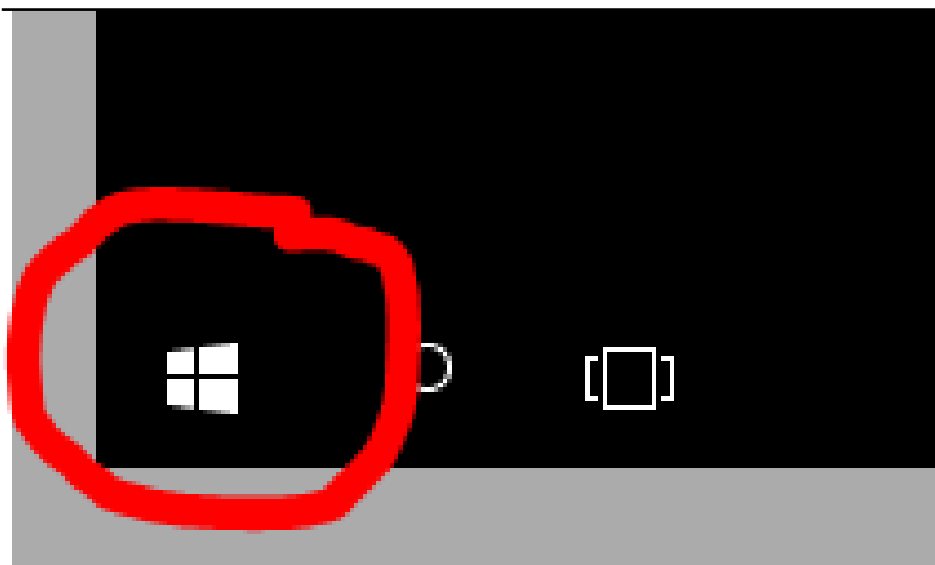

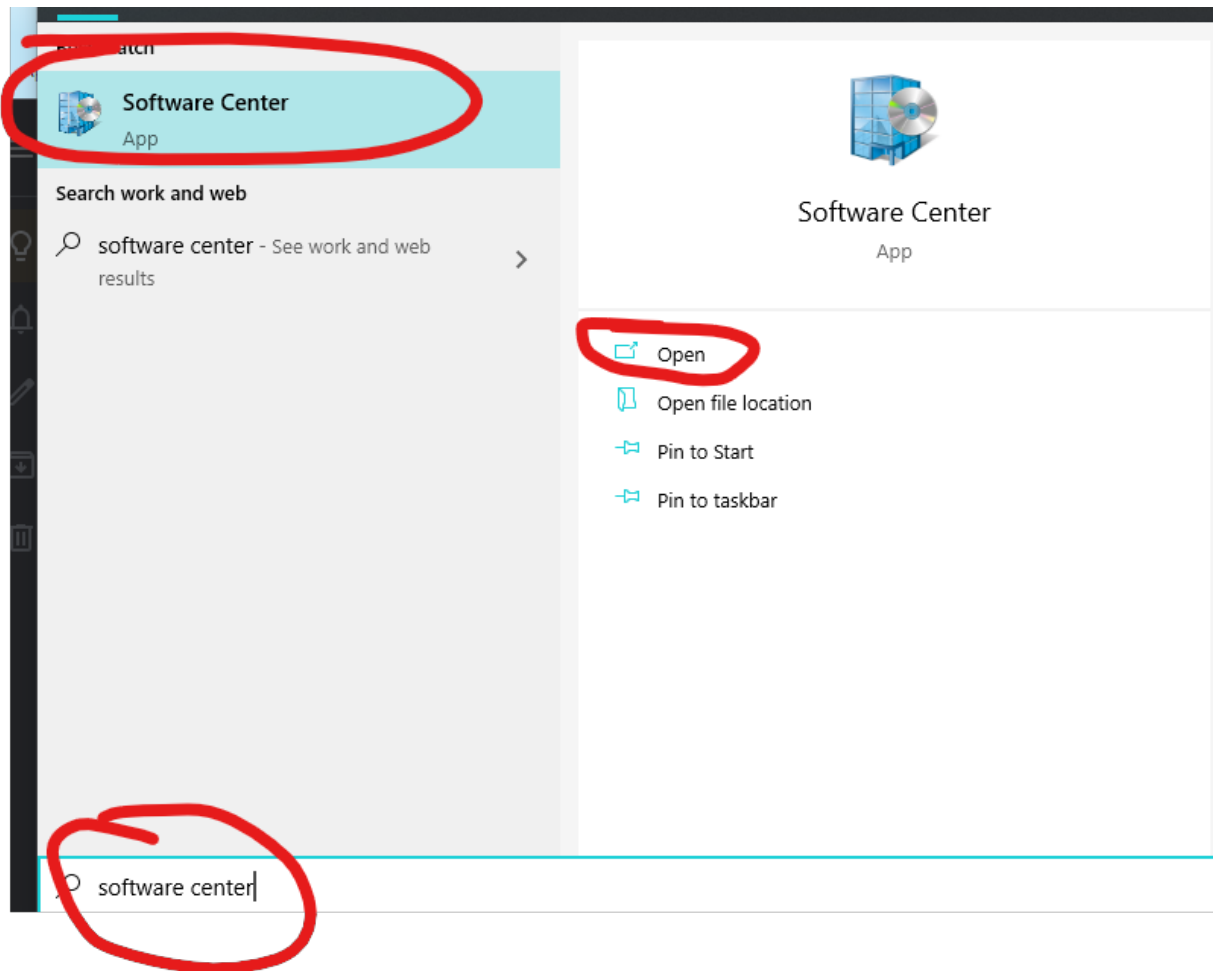

Software Center may take a few minutes to fully open and load.

8. After the Software Center app loads click the "**Operating Systems**" tab on the left-hand menu,

9. In the Operating Systems screen click on the newest available update for your system (either **1709,1809,1909**, or **20H2**)

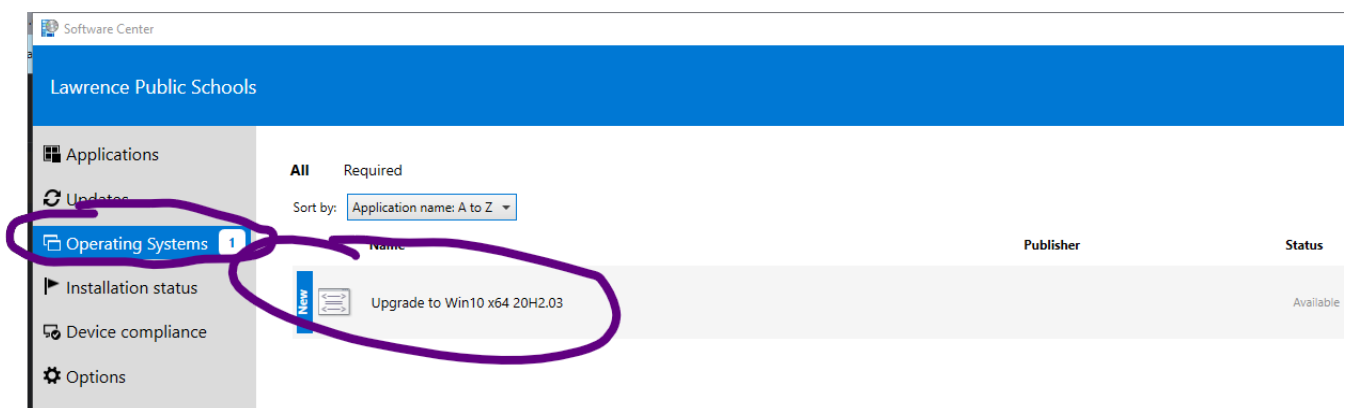

10. At the update install screen click the **Install** button.

11. A warning pop-up will appear to notify you of the changes that will occur. Click the **Install** button on

the pop-up window to begin the update.



Upgrade to Win10 x64 20H2.03

Install

Status: Available

Date published: 6/7/2021

Restart required: Yes

Download size: 15360 MB

Estimated time: 120 minutes

Total components: 1

12. The update will begin to take place. A pop-up window with a **status bar** will appear in your screen after a few minutes to indicate the progress of the update.

Your device may restart multiple times during the update process. Please wait until the update is complete before attempting to use the device.

13. Once the update is complete you may log in with your LPS account and use your device as normal.

Online URL: <https://kb.lawrence.k12.ma.us/article.php?id=1086>